

# DT52S

## Curtain Motor Specification

Version NO. : G/05

### T Product characteristics

Technical support

Pls read the instruction before assembly.

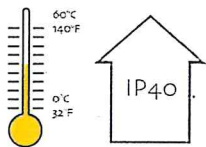

Choose the straight track or curved rail according your need curved rail can use the bracket for connecting



The bracket for connecting

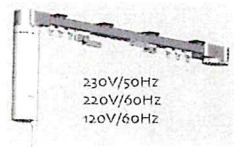

### T Notes

Technical support

Don't use the motorized curtain system vertically or unflatly.

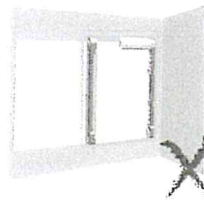

Assembly the motorized curtain system horizontally.

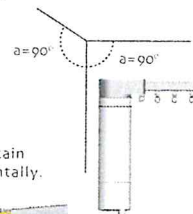
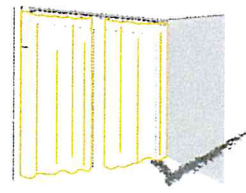

### T Assembly dimension

Technical support

Min = 35mm(1.4in)

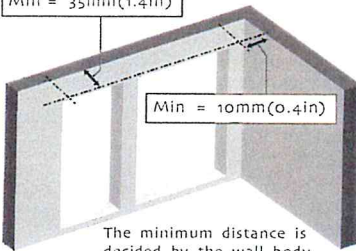

The minimum distance is decided by the wall body.

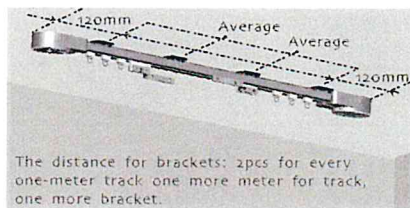

The distance for brackets: 2pcs for every one-meter track one more meter for track, one more bracket.

Bracket is required for the engrating track point.



### T Inspection for motor buttons

Technical support

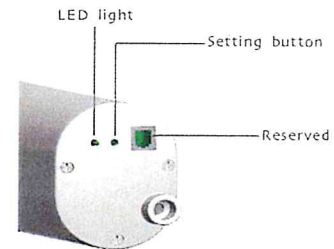

### T Motor function

Technical support

Electronic

Electronic limit+Resistance and stop function+Limit memorized after power off+external electricity switch control



DT52S

# M

## The assembly of rubber belt for curtain motor

Installation  
method

- 1** The confirmation of profiled material dimension

**S track** The length of profiled material =  
The total length of track - 14.8cm

**A track** The length of profiled material =  
The total length of track - 14.8cm

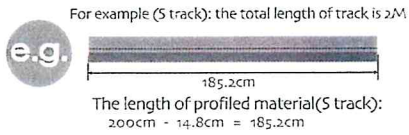

- 2** The confirmation of rubber belt dimension

**S track** The length of rubber belt =  
(The total length of track x 2) - 4.5cm

**A track** The length of rubber belt =  
(The total length of track x 2) - 5.5cm

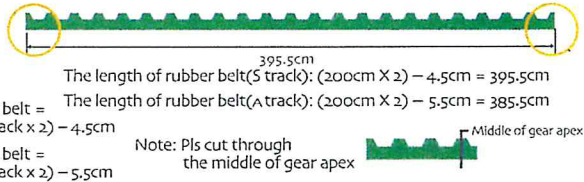

- 3** Pls leave half gear at both ends when assemble rubber belt fastening button

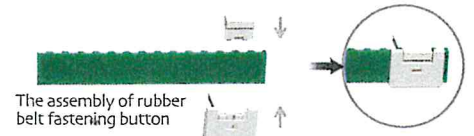

- 4** Pls leave one gear at middle of two rubber belt fastening button when assemble rubber belt fastening button at the middle point of rubber belt

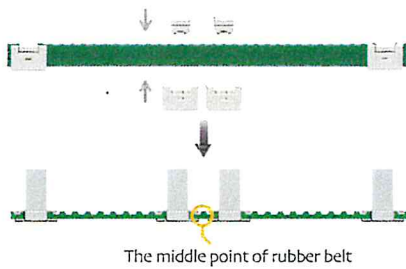

- 5** Fold the rubber belt and assemble the rubber belt fastening button into the master carrier over lap arm

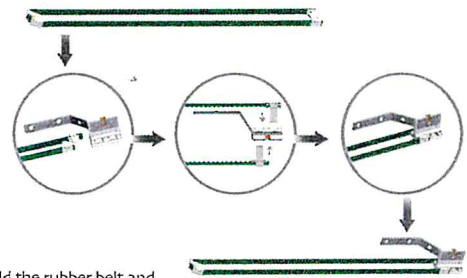

pls confirm which one you bought, the old type or the new type? The following installation for hook is for the new type, if you buy the old type, pls assemble the hooks after finishing the step **9**

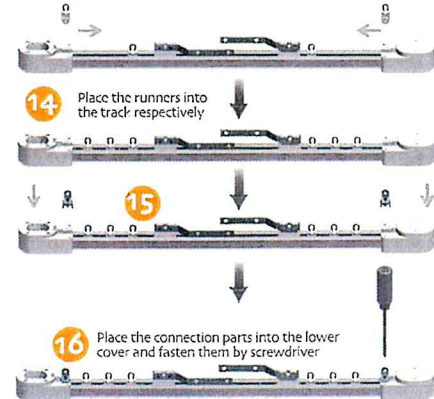
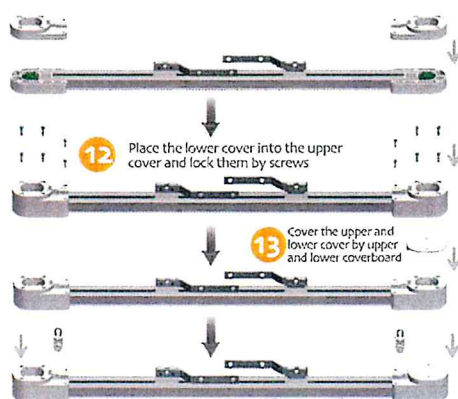
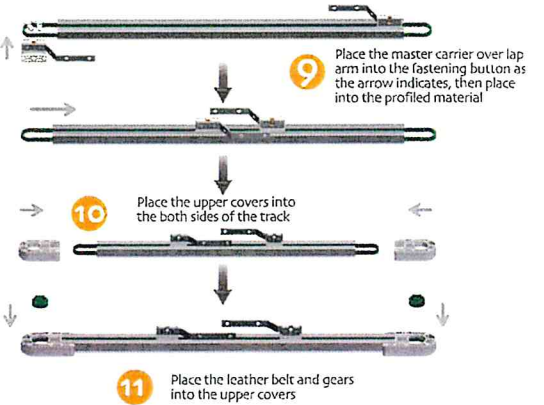
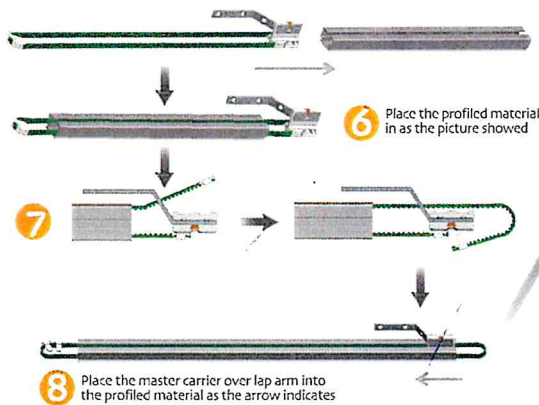

# M

## Folding method for joint track (for easy transit)

Installation method

### Track Folding Method

- 1 Find the overlap arm which is connected to the two ends of rubber belt.
- 2 Screw off the overlap arm and track connection bracket.
- 3 Push track connection bracket to one end.
- 4 Move the overlap arm main body by hand gently, simultaneously undraw the track joint point.
- 5 Fold the track.

### Restoring the track

- 1 Unfold the folding track
- 2 Combine the track gently
- 3 Push the track connection bracket to the joint point.
- 4 PScrew the track connection bracket and mount the overlap arm.
- 5 Restoring the track is finished.

# M

## The installation for curtain motor and cable

Installation method

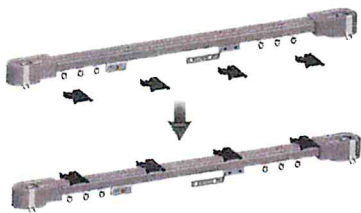

- 1 Check the position of brackets, fix it at an appropriate place on the track

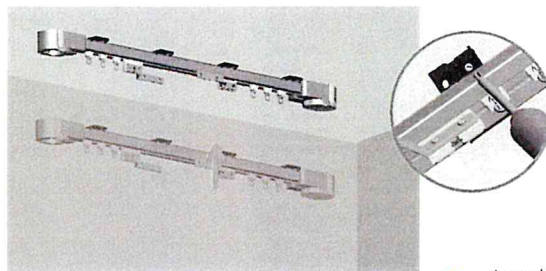

- 2 Assemble the curtain motor track at appropriate place, then fix with screws

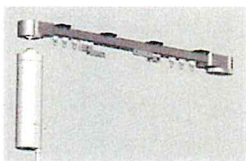

- 3 Assemble the motor

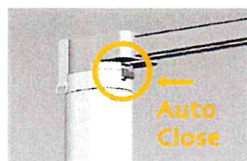

- 4 Pls check assembling is ok

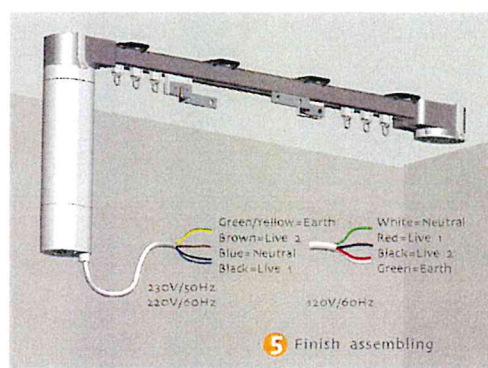
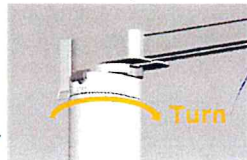
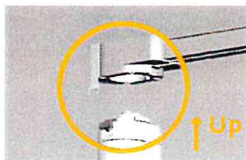

- 5 Finish assembling

# C

## Common switches for curtain motor

Control system

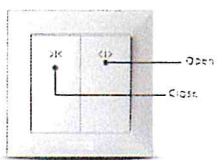

**DC865D**  
Can bounce switch(mechanic)

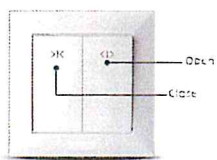

**DC866D**  
Can not rebound switch(mechanic)

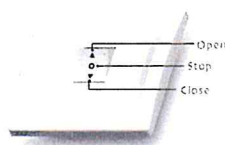

**DC87**  
Single manual switch (mechanic)

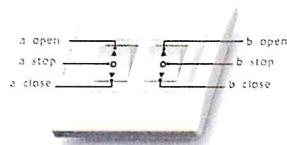

**DC86**  
Double manual switch (mechanic)

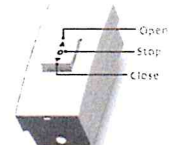

**DC89**  
Single manual rebound switch (mechanic)



# Connection

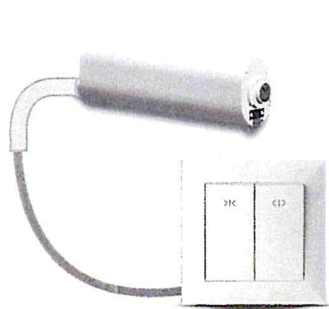

DCB66D  
Can not rebound switch(mechanic)

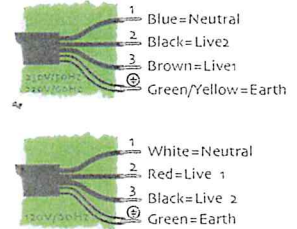
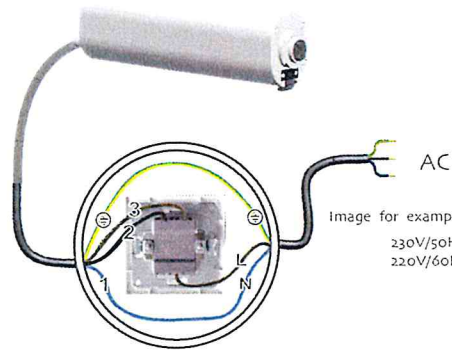

# Set limit position and cancel the limit



- ①this motor have limit memorize function,After the limit setting,black out and do not move the curtain,the limit will remain unchanged after power on.
- ②if pull the curtain after blackout,the limit memory will be erased.Power on again,the motor will auto set the limit once again.(If the limit can not be auto setting,you can use the switch to turn the motor move opsite to active the auto setting.)
- ③After installing the track,you need to remove the current limits, then reset the new limits.

